



Ganghwa Island is known as the roofless museum of Korea because it offers a taste of Korea's rich heritage. Ganghwa's tangible and intangible heritage guides our project which focuses on PUBLIC NEIGHBORHOOD SPACES and DAILY SURROUNDINGS.

Problematic: How to improve Ganghwa's citizens life while enhancing tourist Attraction & economic development of this historical city?

Concept: To link the public spaces in a labyrinth hierarchy with the daily social surroundings.

Section AA'

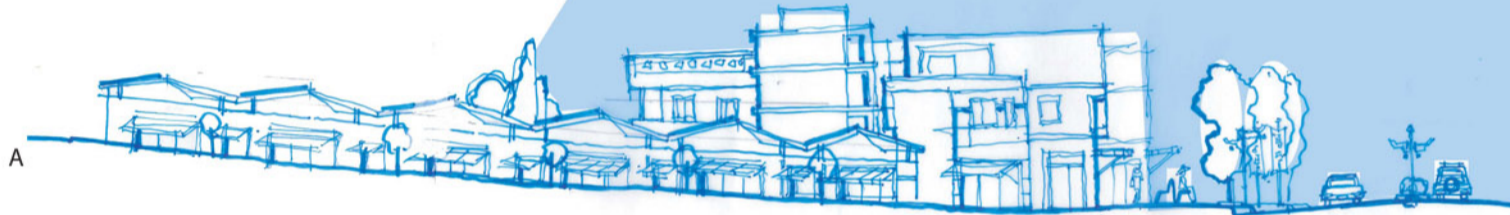
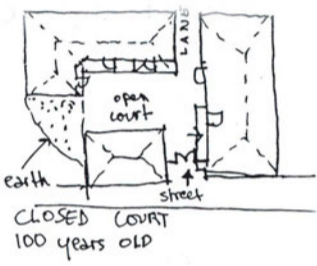

Master plan

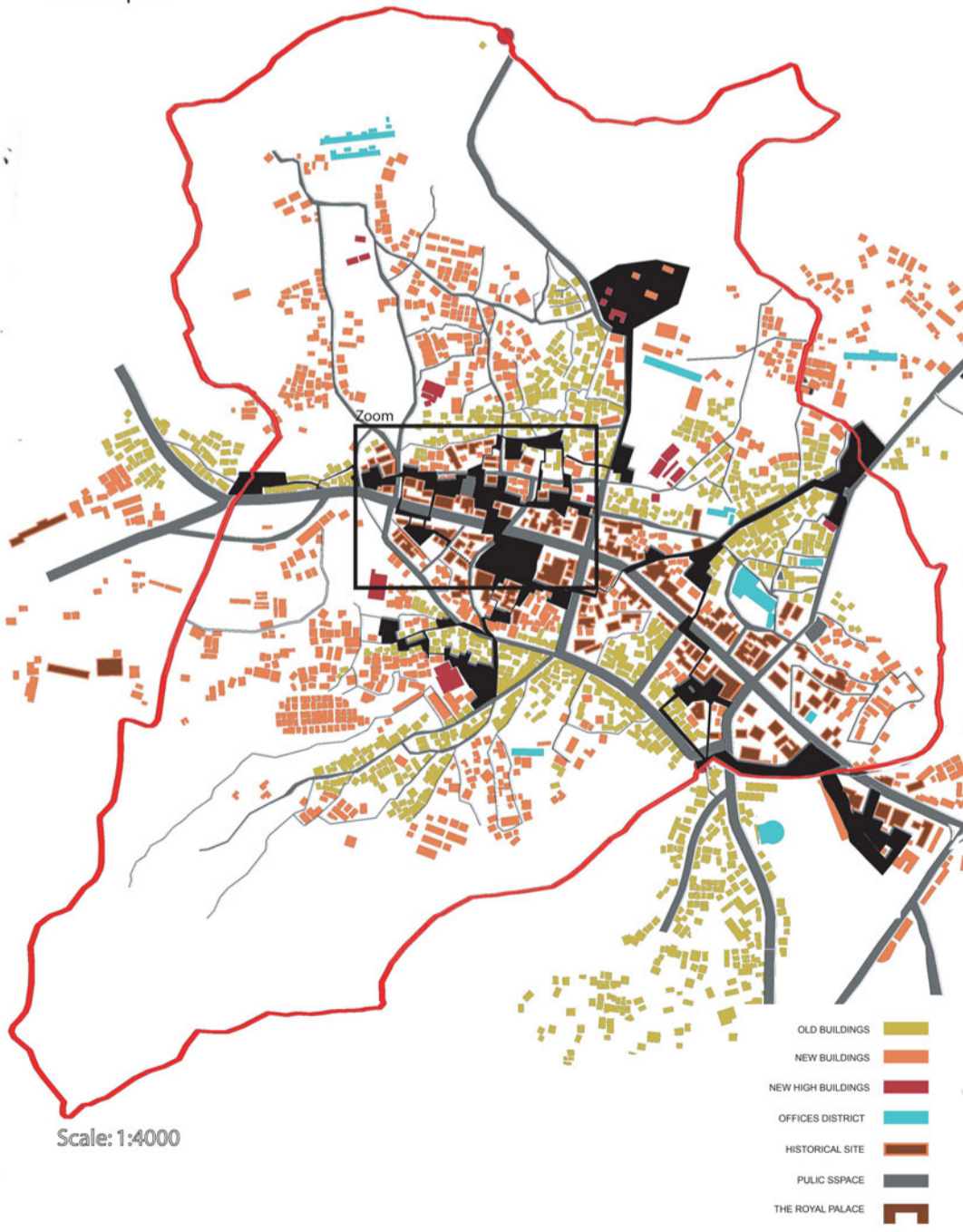
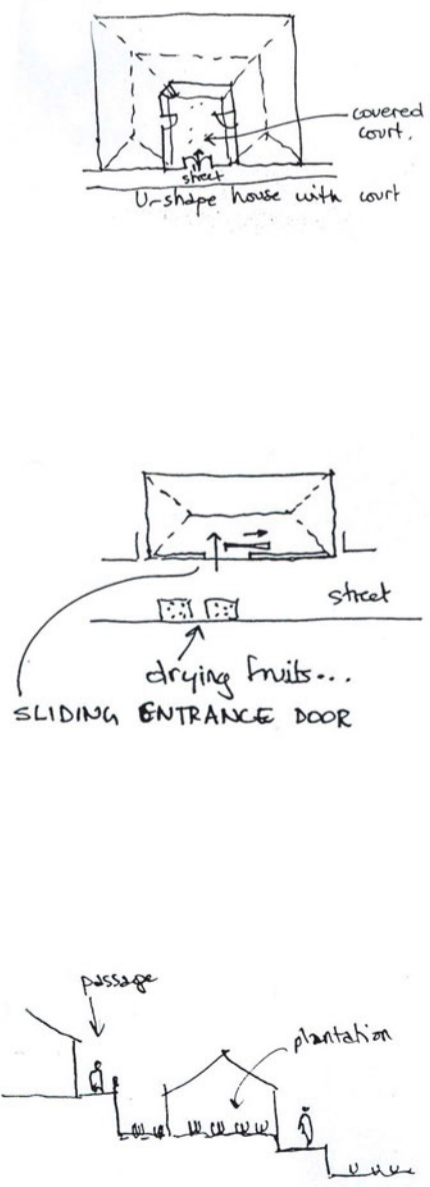

Scale: 1:4000